



Cat.no.:E-PS



Cat.no.:E-FBV



Cat.no.:E-TMBV

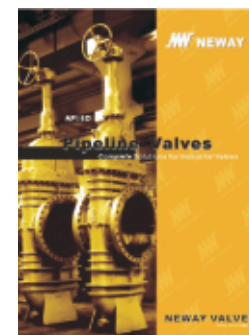

Cat.no.:E-PLV



Cat.no.:E-TOV



Cat.no.:E-DOV



Cat.no.:E-GGC



Cat.no.:E-AV



Cat.no.:E-DAV

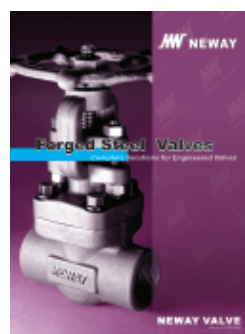

Cat.no.:E-FSV



Cat.no.:E-CSS



Cat.no.:E-CSC

NW NEWAY
NEWAY VALVE (SUZHOU) CO., LTD.

No.666 Taishan Road, New District,
Suzhou,P.R. China
Post Code:215129
Tel: 86-512-666-15637
Fax: 86-512-666-51360
E-Mail: overseas.sales@neway.com.cn
<https://www.newayvalve.com>

Distributed by:

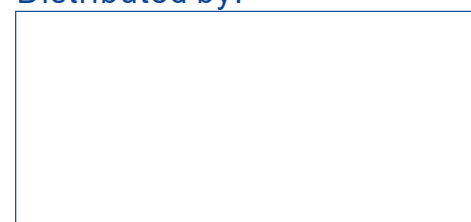

Cat.no.:E-SSV-2022

NW NEWAY

API 603 / ASME B16.34

Cast Stainless Steel Gate, Globe & Check Valves

Corrosion Resistant

Complete Solutions for Industrial Valves

NEWAY VALVE

Cat.no.:E-SSV-2022

Table of Contents

Introduction

- 1 Quality Commitment
- 2 How to Order
- 3 Product Introduction

API603 Gate Valve

- 4 1/2"~1-1/2" (15-40mm)
Flanged, Threaded or Socket Weld

Globe Valve

- 5 1/2"~1-1/2" (15-40mm)
Flanged, Threaded or Socket Weld

Check Valve

- 6 1/2"~1-1/2"(15-40mm)
Flanged, Threaded or Socket Weld

API603 Gate Valve

- 7 2"~24" (50-600mm, CLASS 150)
Flanged

- 8 2"~16" (50-400mm, CLASS 300)
Flanged

Globe Valve

- 9 2"~12" (50-300mm)
Flanged

Check Valve

- 10 2"~16" (50-400mm)
Flanged

- 11 Low Fugitive Emission Control

- 12 NEWAY Factory



Complete Solutions for Industrial Valves

As a global leader of valve manufacturing, Neway (SSE:603699) is dedicated to the production, research, and development of industrial valves. Neway is committed to providing complete valve solutions to all industries through advanced engineering and innovation.

Neway's product line includes Ball, Gate, Globe, Check, Butterfly, Nuclear, Control, Subsea, Safety valves. Our high quality standards and innovative ability are recognized by many global end users and EPCs. Neway valves are utilized in a wide variety of industries and working conditions such as Gas, Oil, Refining, Chemical, Coal Chemical, Offshore, FPSO, Air Separation, LNG, Nuclear Power, Power Generation, and Pipeline Transmission applications.

Facilities & Service

Neway has developed a sophisticated multi-plant management system operating one valve assembly plant, one API6A valve plant, three foundries, and one R&D center. Our newest assembly plant was expanded in 2013, and it now covers 35,000 square meters.

Advanced software (ANSYS, FE-Safe, CF-Design, Siemens PLM and NX) is applied here at Neway for the Research & Development of products. We use SAP to control the traceability and status of all products during the manufacturing process. In order to ensure the safety, eco-friendliness, and reliability of our products, we use the most advanced fire-safe, cryogenic, high pressure, and fugitive emission test equipment.

As part of Neway's global strategy, to provide better service to our customers, we have established our overseas subsidiaries in North America, Brazil, Netherlands, Italy, Singapore, and Dubai along with over 80 agents and distributors worldwide.

High Quality, High Value

Neway is dedicated to continuous improvement. We maintain a quality management system that encompasses our entire operation from order entry to final inspection. Through continuous efforts, Neway's products have successfully obtained industry certifications, including ASME UV & NB, NBBI, KGS, CE, CCS, and BV approvals.

Quality Commitment

Neway recognizes the importance of valve quality for the safety and protection of personnel health and property. It is our quality commitment to focus our resources to provide our customers with first class products at a competitive price, that are designed, manufactured, inspected and tested in accordance with our customer's specifications and that comply with all international standards.

With respect to the facts that the current industrial standards do not always take into consideration the likelihood and consequences of possible deterioration in service, related to specific service fluids or the external environment in which they operate. Our customers are requested to keep an open line of communication with our engineering department to identify and implement standards, that will provide valves with the possibility of deterioration in service, so as to ensure safety over the valves expected lifetime.



Figure Number Example:

3

①

GDC

②

1

③

R

④

-

M

⑤

,

S01

⑥

/

12B

⑦

Neway valve figure numbers are designed to cover essential features. When ordering, please show figure numbers to avoid misunderstanding of your requirements. However a detailed description must accompany any special orders.

Following descriptions provide a basic guideline in valve specification.

① Valve Size

② Valve Type

Valve Type	Gate Valve	Globe Valve	Swing Check
Symbol	GDC	GLD	SDC

③ Class

Class	150	300	600
Symbol	1	3	6

④ End Connection

End Connection	Socket Weld End	NPT Threaded End	Butt Weld End	Threaded×Socket	Raised Flange	RTJ Flange
Symbol	S	N	B	SN	R	J

⑤ Actuator or Special Code

Description	Gear Operator	Electric Actuator	Pneumatic Actuator
Symbol	G	M	P

⑥ Body Materials

Body Materials	S00	S01	S02	S03	S04	S06	CN7M
ASTM Ref.	A351 Gr. CF8	A351 Gr. CF8M	A351 Gr. CF3	A351 Gr. CF3M	A351 Gr. CF8C	A351 Gr. CG8M	Alloy 20

⑦ Trim Materials

Symbol	Wedge or Disc Surface	Seat Surface	Stem Materials
2	304	Integral	ASTM A182 Grade F304
10	316	Integral	ASTM A182 Grade F316
28B	Stellite	Integral	ASTM A182 Grade F304
12B	Stellite	Integral	ASTM A182 Grade F316

Note: Other materials upon request.

DC series valves are thin walled valve designs which take advantage of the non-corrosive nature of the material to reduce wall thickness. These valves are built to meet all ASME B16.34 requirements and reduce excessive bulkiness to the valve, saving weight and material.

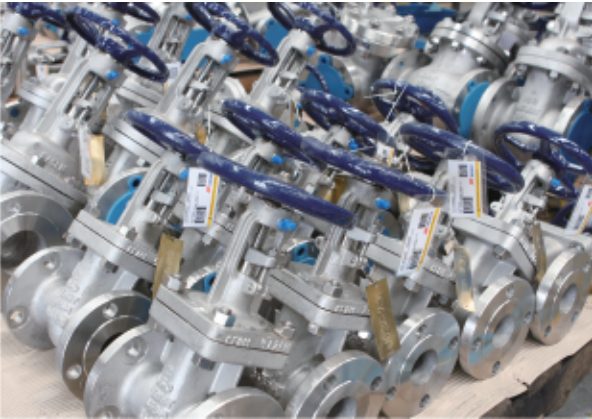

Product Introduction

Size Range:	1/2"~24" (DN15~DN600)
Wall Thickness:	ASME B16.34
Valve Type:	Gate Valve, Globe Valve, Check Valve
Rating :	CLASS 150~600 (PN20~100)
Body Materials:	Stainless Steel
End Connection:	Flanged; Threaded; Socket Weld
Application:	Petrochemical, Pulp and paper, Chemical; Medicine, Food Industrial etc...

Product Range

Valve Type & Class		CLASS 150~300 CAST STAINLESS STEEL GATE, GLOBE & CHECK VALVE														FLANGED		
		1/2 15	3/4 20	1 25	1-1/2 40	2 50	2-1/2 65	3 80	4 100	6 150	8 200	10 250	12 300	14 350	16 400	18 450	20 500	24 600
Gate	150	x	x	x	x	x	x	x	x	x	x	x	x	x	x	x	x	x
	300	x	x	x	x	x	x	x	x	x	x	x	x	x	x	x	x	x
Globe	150	x	x	x	x	x	x	x	x	x	x	x	x					
	300	x	x	x	x	x	x	x	x	x	x	x	x					
Check	150	x	x	x	x	x	x	x	x	x	x	x	x	x	x	x	x	x
	300	x	x	x	x	x	x	x	x	x	x	x	x	x	x	x	x	x

Valve Type & Class		CLASS 600 CAST STAINLESS STEEL GATE, GLOBE & CHECK VALVE														THREADED & SOCKET WELD		
		1/2 15	3/4 20	1 25	1-1/2 40													
Gate		x	x	x	x													
Globe		x	x	x	x													
Check		x	x	x	x													

API603 Gate Valve
1/2"~1-1/2" (DN15~DN40)

Flanged, Threaded or Socket Weld

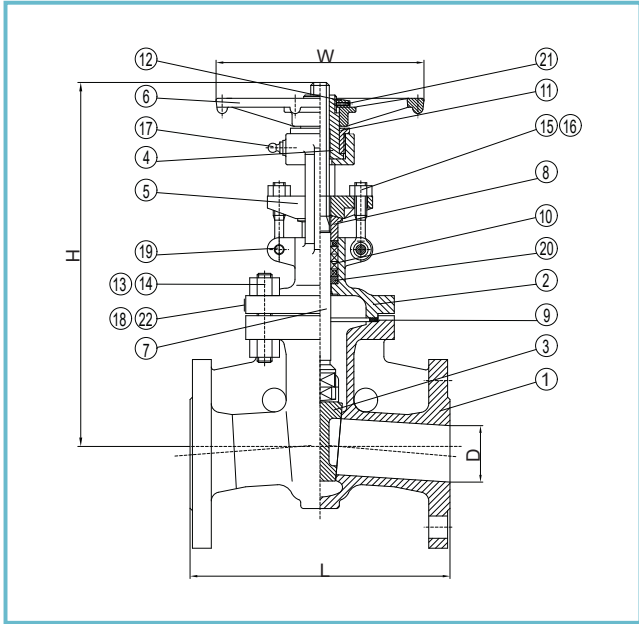

Flanged,
ASME CLASS 150~300 (PN 20~50)
Integral Seat

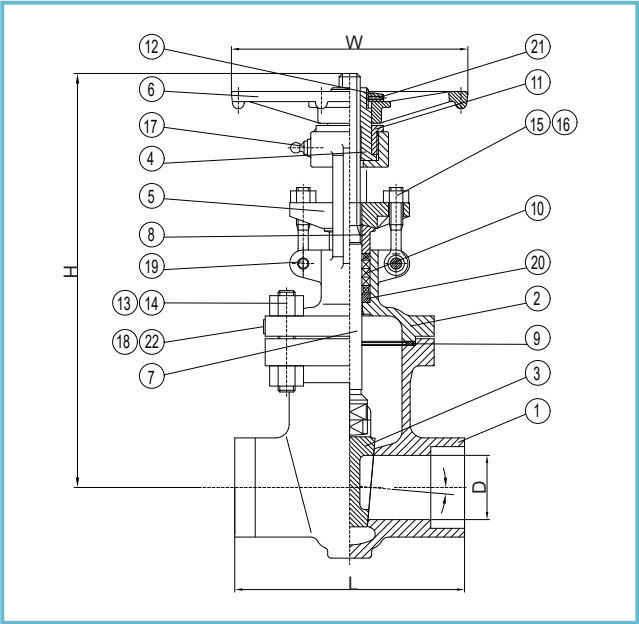

Threaded or Socket Weld,
ASME CLASS 600 (PN 100)
Integral Seat

Material List

No	Part Name	Material
1	BODY	ASTM A351 CF8M
2	BONNET	ASTM A351 CF8M
3	WEDGE	ASTM A351 CF8M
4	STEM NUT	ASTM A439 D-2C / Bronze / D-2
5	GLAND FLANGE	ASTM A351 CF8
6	HANDWHEEL	ASTM A538 60-40-18
7	STEM	ASTM A182 F316
8	GLAND	ASTM A276 F316L
9	GASKET	316+PTFE OR 316+GRAPHITE
10	PACKING	PTFE OR GRAPHITE
11	RETAINING NUT	ASTM A276 304

No	Part Name	Material
12	HANDWHEEL NUT	ASTM A276 304 / 316
13	STUD	ASTM A193-B8 CL2
14	NUT	ASTM A194-8
15	EYE BOLT	ASTM A193-B8
16	NUT	ASTM A194-8
17	GREASE FITTING	ASTM A276 304 / 316
18	RIVET	ASTM A276 316
19	PIN	ASTM A276 304 / 316
20	SPACER RING	ASTM A276 F316L
21	SCREW	ASTM A276 304 / 316
22	NAME PLATE	ASTM A240 316

Dimensions and Weights

Size	Flanged, ASME CLASS 150 (PN 20)					Flanged, ASME CLASS 300 (PN 50)					Threaded-Socket Weld, ASME CLASS 600 (PN100)				
in mm	D	L	W	H	Weight lb(kg)	D	L	W	H	Weight lb(kg)	D	L	W	H	Weight lb(kg)
1/2	0.59	4.25	4.72	8.15	7.4	0.59	5.51	4.72	8.15	13.0	0.50	3.43	4.72	8.29	6.8
15	15	108	120	207	3.4	15	140	120	207	5.9	15	87	120	210.5	3.1
3/4	0.75	4.61	4.72	8.15	8.3	0.75	5.98	4.72	8.15	16.0	0.75	3.43	4.72	8.29	7.0
20	19	117	120	207	3.8	19	152	120	207	7.3	19	87	120	210.5	3.2
1	0.98	5.00	4.72	8.66	10.0	0.98	6.50	5.51	9.69	24.0	1.00	4.13	5.51	10.02	10.7
25	25	127	120	220	4.5	25	165	140	246	10.9	25	105	140	254.5	4.9
1-1/2	1.50	6.50	6.30	9.76	18.0	1.50	7.52	7.87	11.69	39.0	1.50	4.92	7.87	12.28	19.5
40	38	165	160	248	8.2	38	191	200	297	17.7	38	125	200	312	8.8

API603 Gate Valve
2"~24" (DN50-DN600,

Flanged

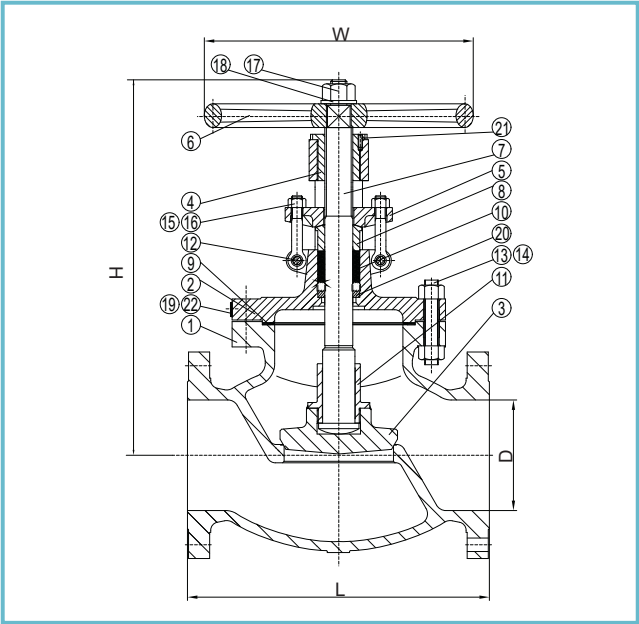

Flanged,
ASME CLASS 150~300 (PN 20~50)
Integral Seat

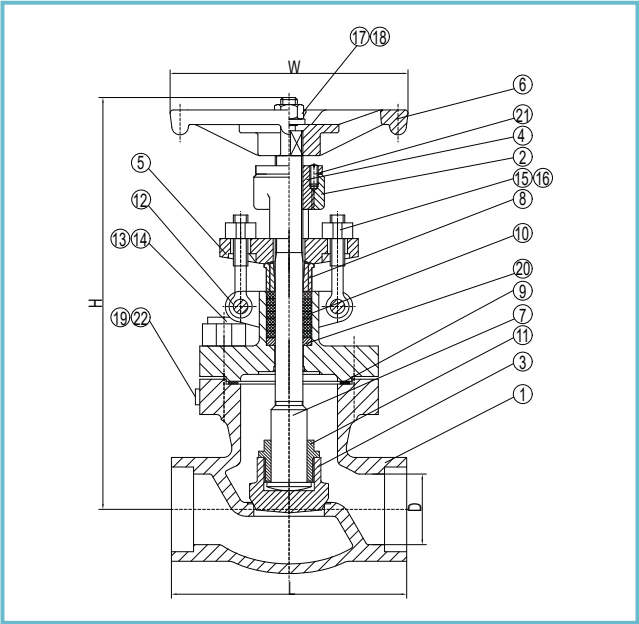

Threaded or Socket Weld,
ASME CLASS 600 (PN 100)
Integral Seat

Material List

No	Part Name	Material
1	BODY	ASTM A351 CF8M
2	BONNET	ASTM A351 CF8M
3	WEDGE	ASTM A351 CF8M
4	STEM NUT	ASTM A439 D-2C / D-2 / Bronze
5	GLAND FLANGE	ASTM A351 CF8
6	HANDWHEEL	ASTM A538 60-40-18
7	STEM	ASTM A182 F316
8	GLAND	ASTM A276 F316L
9	GASKET	316L+PTFE OR 316L+GRAPHITE
10	PACKING	PTFE OR GRAPHITE
11	RETAINING NUT	ASTM A276 304
12	HANDWHEEL NUT	ASTM A276 304 / 316
13	STUD	ASTM A193-B8 CL2

No	Part Name	Material
14	NUT	ASTM A194-8
15	EYE BOLT	ASTM A193-B8
16	NUT	ASTM A194-8
17	GREASE FITTING	ASTM A276 304 / 316
18	RIVET	ASTM A276 316
19	PIN	ASTM A276 304 / 316
20	SPACER RING	ASTM A276 F316L
21	SCREW	ASTM A276 304 / 316
22	NAME PLATE	ASTM A240 316
23	STUD	ASTM A193-B8
24	NUT	ASTM A194-8
25	YOKE	ASTM A351 CF8M
26	THRUST BEARING	STAINLESS STEEL

Dimensions and Weights

Size	Flanged, ASME CLASS 150 (PN 20)				
in mm	D	L	W	H	Weight lb(kg)
2	2.01	7.01	7.08	11.42	27.0
50	51	178	180	290	12.2
2-1/2	2.52	7.48	7.08	13.19	37.5
65	64	190	180	335	17.0
3	2.99	7.99	7.87	15.20	46.3
80	76	203	200	386	21.0
4	4.02	9.02	9.84	17.52	75.0
100	102	229	250	445	34.0
6	5.98	10.51	11.81	23.27	128.0
150	152	267	300	591	58.1
8	7.99	11.50	13.78	28.74	216.1
200	203	292	350	730	98.0
10	10.00	12.99	15.75	34.76	291.1
250	254	330	400	883	132.0
12	12.01	14.02	17.72	39.96	436.6
300	305	356	450	1015	198.0
14	13.27	15.00	19.69	44.53	703.4
350	337	381	500	1131	319.1
16	15.24	15.98	21.65	50.59	1018.7
400	387	406	550	1285	462.1
18	17.24	17.01	23.62	74.49	1190.7
450	438	432	600	1892	540.1
20	19.25	17.99	26.77	83.23	1631.7
500	489	457	680	2114	740.1
24	23.27	20.00	29.92	98.43	2434.3
600	591	508	760	2500	1104.2

API603 Gate Valve
2"~16" (DN50~DN400, CLASS 300)

Flanged

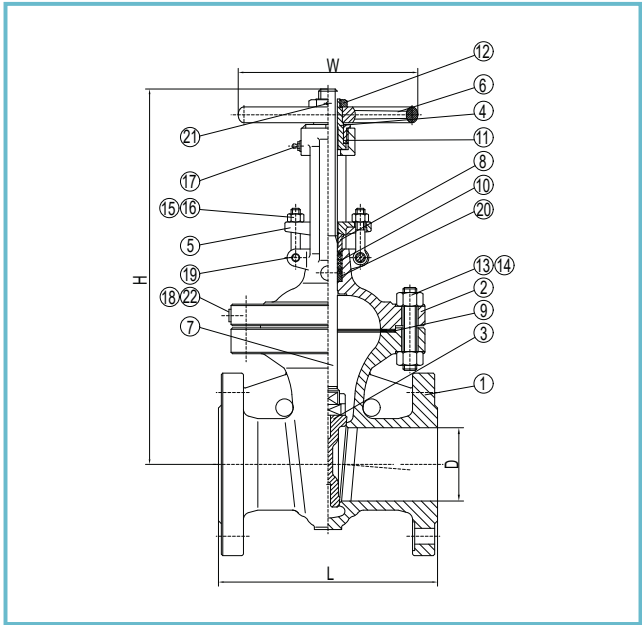

Flanged, ASME CLASS 300 (PN50, DN50~200)
Integral Seat; flexible wedge(solid wedge only for DN50);
Optional Stellite Seat Face

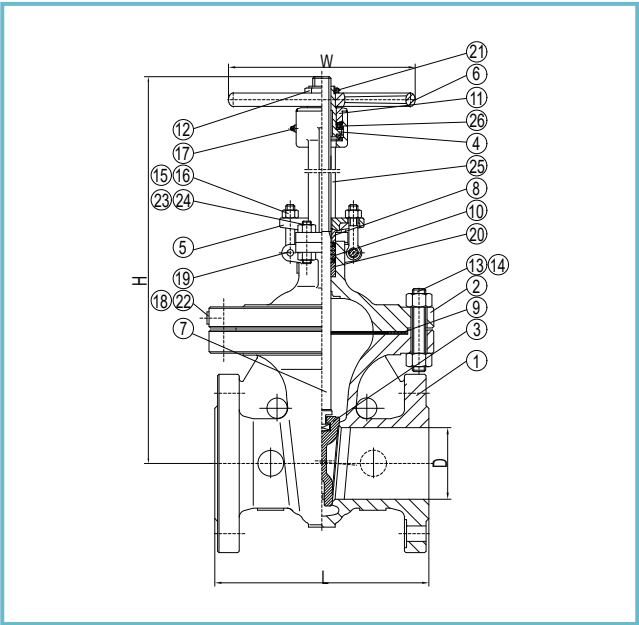

Flanged, ASME CLASS 300 (PN50, DN250-400)
Integral Seat; flexible wedge; Optional Stellite Seat Face

Material List

No	Part Name	Material
1	BODY	ASTM A351 CF8M
2	BONNET	ASTM A351 CF8M
3	WEDGE	ASTM A351 CF8M
4	STEM NUT	ASTM A439 D-2C / D-2 / Bronze
5	GLAND FLANGE	ASTM A351 CF8
6	HANDWHEEL	ASTM A538 60-40-18
7	STEM	ASTM A182 F316
8	GLAND	ASTM A276 F316L
9	GASKET	316L+PTFE OR 316L+GRAPHITE
10	PACKING	PTFE OR GRAPHITE
11	RETAINING NUT	ASTM A276 304
12	HANDWHEEL NUT	ASTM A276 304 / 316
13	STUD	ASTM A193-B8 CL2

No	Part Name	Material
14	NUT	ASTM A194-8
15	EYE BOLT	ASTM A193-B8
16	NUT	ASTM A194-8
17	GREASE FITTING	ASTM A276 304 / 316
18	RIVET	ASTM A276 316
19	PIN	ASTM A276 304 / 316
20	SPACER RING	ASTM A276 F316L
21	SCREW	ASTM A276 304 / 316
22	NAME PLATE	ASTM A240 316
23	STUD	ASTM A193-B8
24	NUT	ASTM A194-8
25	YOKE	ASTM A351 CF8M
26	THRUST BEARING	STAINLESS STEEL

Dimensions and Weights

Size in mm	Flanged, ASME CLASS 300 (PN 50)				
	D	L	W	H	Weight lb(kg)
2	2.01	8.50	7.87	11.93	53.0
50	51	216	200	303	24.0
2-1/2	2.52	9.49	7.87	14.33	68.4
65	64	241	200	364	31.0
3	2.99	11.14	9.84	15.51	90.4
80	76	283	250	394	41.0
4	4.02	12.01	9.84	17.83	119.1
100	102	305	250	453	54.0
6	5.98	15.87	13.78	24.57	251.4
150	152	403	350	624	114.0
8	7.99	16.50	15.75	30.04	478.5
200	203	419	400	763	217.0
10	10.00	17.99	17.72	36.18	557.9
250	254	457	450	919	253.1
12	12.01	19.76	19.69	42.99	917.3
300	305	502	500	1092	416.1
14	13.27	30.00	21.65	48.19	957.0
350	337	762	550	1224	434.1
16	15.24	32.99	23.62	51.93	1206.1
400	387	838	600	1319	547.1

Globe Valve
1/2"~1-1/2" (DN15~DN40)

Flanged, Threaded or Socket Weld

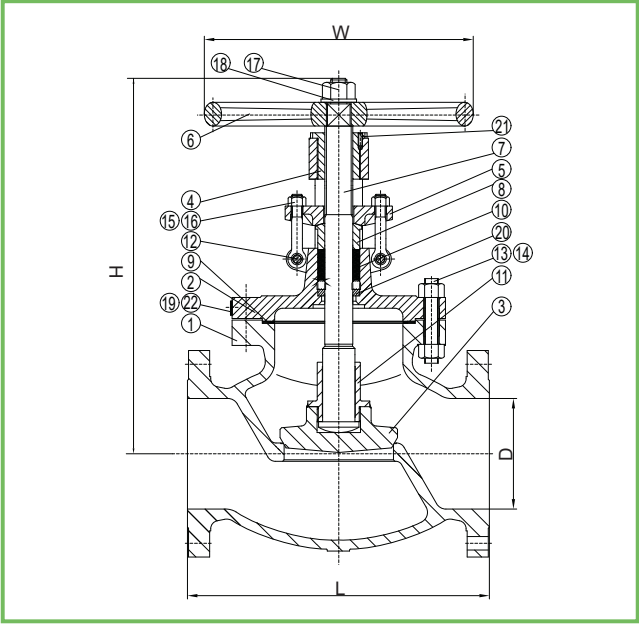

Flanged,
ASME CLASS 150-300 (PN 20-50)
Integral Seat

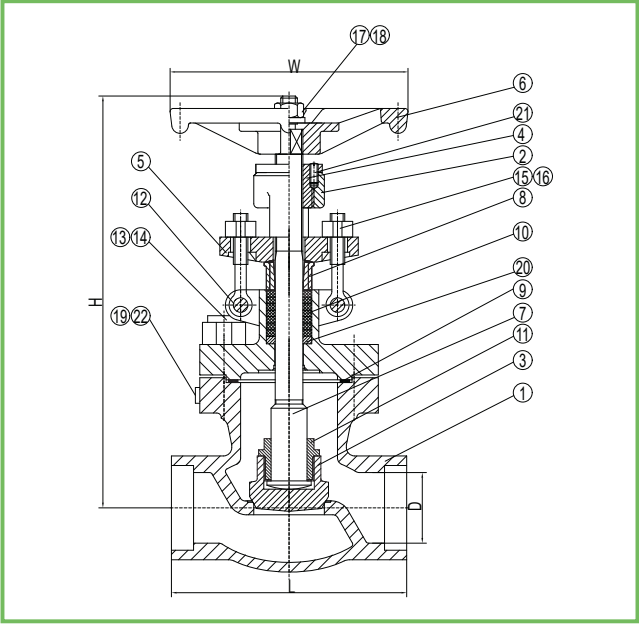

Threaded or Socket Weld,
ASME CLASS 600 (PN 100)
Integral Seat

Material List

No	Part Name	Material
1	BODY	ASTM A351 CF8M
2	BONNET	ASTM A351 CF8M
3	DISC	ASTM A182 F316
4	STEM NUT	ASTM A439 D-2C / D-2 / Bronze
5	GLAND FLANGE	ASTM A351 CF8
6	HANDWHEEL	ASTM A538 60-40-18
7	STEM	ASTM A182 F316
8	GLAND	ASTM A276 F316L
9	GASKET	316L+PTFE OR 316L+GRAPHITE
10	PACKING	PTFE OR GRAPHITE
11	DISC NUT	ASTM A276 F316

No	Part Name	Material
12	PIN	ASTM A276 304 / 316
13	STUD	ASTM A193-B8 CL2
14	NUT	ASTM A194-8
15	EYE BOLT	ASTM A193-B8
16	NUT	ASTM A194-8
17	HANDWHEEL NUT	ASTM A276 304 / 316
18	WASHER	ASTM A276 304 / 316
19	RIVET	ASTM A276 316
20	SPACER RING	ASTM A276 F316L
21	SCREW	ASTM A276 304 / 316
22	NAME PLATE	ASTM A240 316

Dimensions and Weights

Size in mm	Flanged, ASME CLASS 150 (PN 20)					Flanged, ASME CLASS 300 (PN 50)					Threaded-Socket Weld, ASME CLASS 600 (PN 100)				
	D	L	W	H	Weight lb(kg)	D	L	W	H	Weight lb(kg)	D	L	W	H	Weight lb (kg)
1/2	0.59	4.25	3.94	8.03	7.6	0.59	5.98	3.94	7.28	13.0	0.50	3.74	3.94	7.82	12.0
15	15	108	100	203.9	3.4	15	152	100	185	5.9	15	95	100	198.7	5.4
3/4	0.75	4.61	3.94	8.22	8.9	0.75	7.01	3.94	7.43	17.0	0.75	4.25	3.94	7.82	12.0
20	19	117	100	208.7	4.0	19	178	100	188.7	7.7	19	108	100	198.7	5.4
1	0.98	5.00	3.94	8.28	11.6	0.98	7.99	5.91	8.64	25.0	1.00	5.00	5.91	9.39	17.0
25	25	127	100	210.4	5.3	25	203	150	219.5	11.3	25	127	150	238.4	7.7
1-1/2	1.50	6.50	7.87	8.83	16.4	1.50	9.02	7.87	10.41	36.0	1.50	5.98	7.87	11.02	32.0
40	38	165	200	224.4	7.4	38	229	200	264.4	16.3	38	152	200	280	14.5

Globe Valve
2"~12" (DN50~DN300)

Flanged

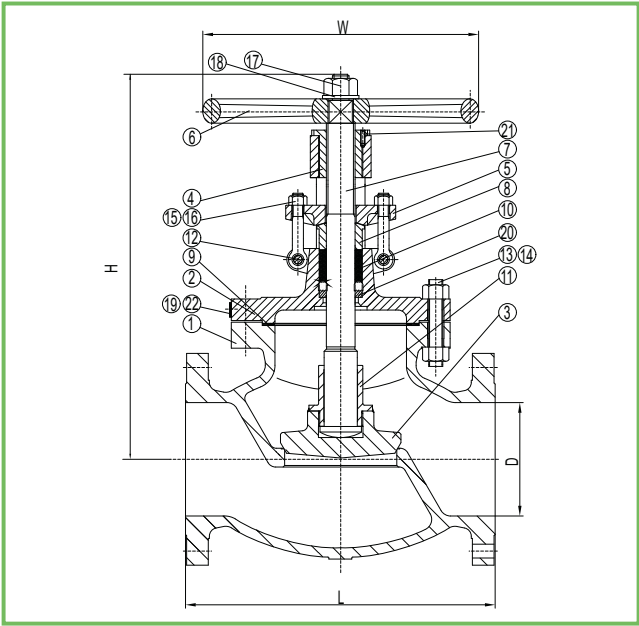

Flanged, ASME CLASS 150~300 (PN 20~50)
Integral Seat; Optional Stellited Seat Face

No	Part Name	Material
1	BODY	ASTM A351 CF8M
2	BONNET	ASTM A351 CF8M
3	DISC	ASTM A182 F316
4	STEM NUT	ASTM A439 D-2C / D-2 / Bronze
5	GLAND FLANGE	ASTM A351 CF8
6	HANDWHEEL	ASTM A538 60-40-18
7	STEM	ASTM A182 F316
8	GLAND	ASTM A276 F316L
9	GASKET	316L+PTFE OR 316L+GRAPHITE
10	PACKING	PTFE OR GRAPHITE
11	DISC NUT	ASTM A276 F316
12	PIN	ASTM A276 304 / 316
13	STUD	ASTM A193-B8 CL2
14	NUT	ASTM A194-8
15	EYE BOLT	ASTM A193-B8
16	NUT	ASTM A194-8
17	HANDWHEEL NUT	ASTM A276 304 / 316
18	WASHER	ASTM A276 304 / 316
29	RIVET	ASTM A240 316
20	SPACER RING	ASTM A276 F316L
21	SCREW	ASTM A276 304 / 316
22	NAME PLATE	ASTM A276 316

Size	Flanged, ASME CLASS 150 (PN 20)					Flanged, ASME CLASS 300 (PN 50)				
in mm	D	L	W	H	Weight lb(kg)	D	L	W	H	Weight lb(kg)
2	2.01	7.99	7.87	9.64	25.2	2.01	10.51	7.87	11.65	54.0
50	51	203	200	244.8	11.4	51	267	200	296	24.5
2-1/2	2.52	8.50	7.87	10.98	46.3	2.52	11.50	9.84	13.30	83.5
65	64	216	200	279	21.0	64	292	250	337.9	37.9
3	2.99	9.49	9.84	13.66	61.7	2.99	12.52	9.84	14.35	92.0
80	76	241	250	346.9	28.0	76	318	250	364.4	41.7
4	4.02	11.50	11.81	15.74	97.0	4.02	14.02	13.78	16.69	130.1
100	102	292	300	399.9	44.0	102	356	350	423.9	59.0
6	5.98	15.98	13.78	17.71	198.5	5.98	17.48	19.69	23.17	317.5
150	152	406	350	449.9	90.0	152	444	500	588.4	144.0
8	7.99	19.49	15.75	19.92	383.7	7.99	22.01	22.05	27.89	562.3
200	203	495	400	506	174.0	203	559	560	708.5	255.1
10	10.00	24.49	19.69	26.06	546.8					
250	254	622	500	662	248.0					
12	12.01	27.48	22.05	30.39	848.9					
300	305	698	560	772	385.1					

Check Valve
1/2"~1-1/2" (DN15~DN40)

Flanged, Threaded or Socket Weld

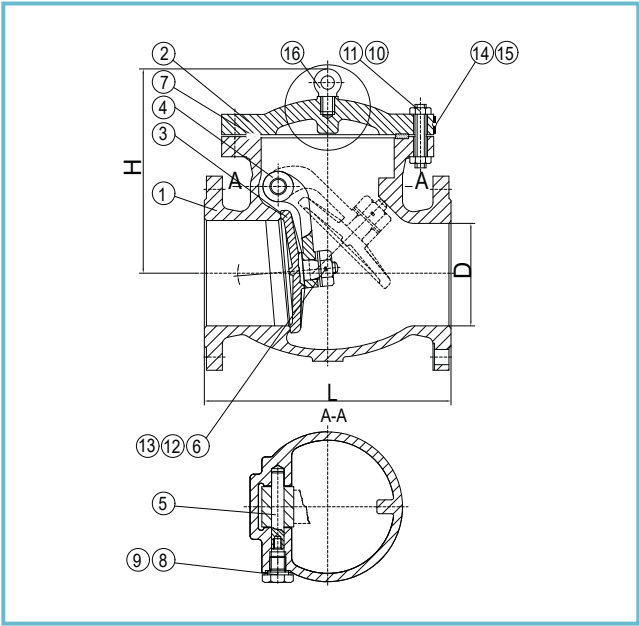

Flanged,
ASME CLASS 150-300 (PN 20-50)
Integral Seat

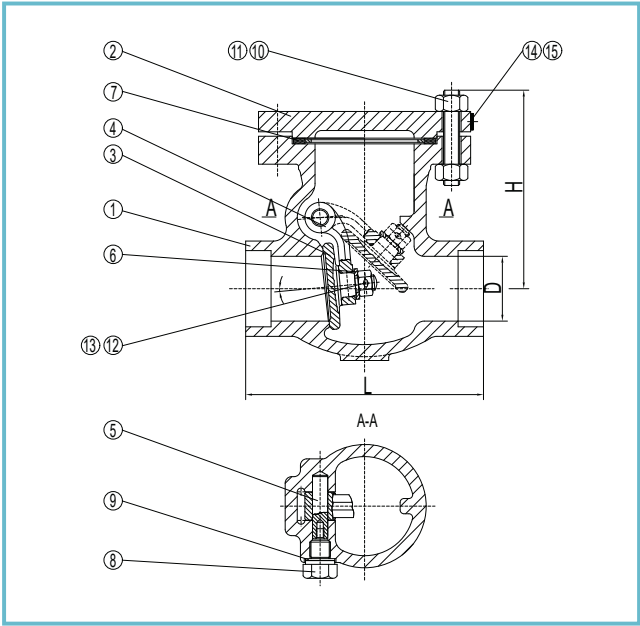

Threaded or Socket Weld,
ASME CLASS 600 (PN 100)
Integral Seat

Material List

No	Part Name	Material
1	BODY	ASTM A351 CF8M
2	COVER	ASTM A351 CF8M
3	DISC	ASTM A182 F316/ ASTM A351 CF8M
4	HINGE	ASTM A351 CF8M
5	HINGE PIN	ASTM A276 316
6	WASHER	ASTM A276 316
7	GASKET	316L+PTFE OR 316L+GRAPHITE
8	PLUG	ASTM A276 316

No	Part Name	Material
9	WASHER	ASTM A276 316
10	STUD	ASTM A193-B8 CL2
11	NUT	ASTM A194-8
12	DISC NUT	ASTM A276 316
13	PIN	ASTM A276 316
14	RIVET	ASTM A276 316
15	NAME PLATE	ASTM A240 316
16	HOOK SCREW	ASTM A276 304

Dimensions and Weights

Size	Flanged, ASME CLASS 150 (PN 20)				Flanged, ASME CLASS 300 (PN 50)				Threaded-Socket Weld, ASME CLASS 600(PN 100)			
in mm	D	L	H	Weight lb(kg)	D	L	H	Weight lb(kg)	D	L	H	Weight lb (kg)
1/2	0.59	4.25	3.54	4.2	0.59	5.98	3.54	16.0	0.50	3.23	3.62	4.2
15	15	108	90	1.9	15	152	90	7.3	15	82	92	1.9
3/4	0.75	4.61	3.54	5.6	0.75	7.01	3.54	18.0	0.75	3.23	3.62	4.2
20	19	117	90	2.5	19	178	90	8.2	19	82	92	1.9
1	0.98	5.00	3.70	8.4	0.98	8.50	3.56	21.0	1.00	4.13	3.78	5.8
25	25	127	94	3.8	25	216	90.5	9.5	25	105	96	2.6
1-1/2	1.50	6.50	4.07	13.5	1.50	9.49	4.51	30.0	1.50	4.92	4.82	10.1
40	38	165	103.5	6.1	38	241	114.5	13.6	38	125	122.5	4.6

Check Valve
2"~16" (DN50-DN400)

Flanged

Low Fugitive Emission Control

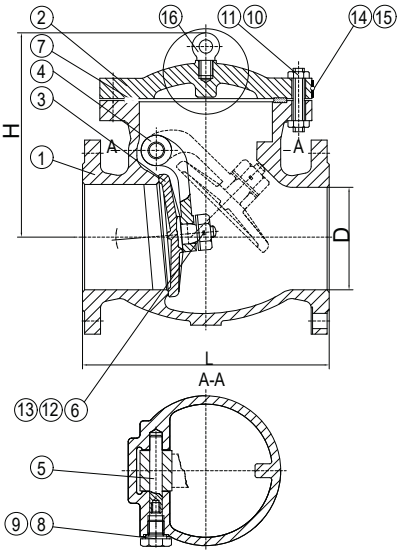

Flanged, ASME CLASS 150~300 (PN20-50)
Integral Seat; Optional Stellite Seat Face

No	Part Name	Material
1	BODY	ASTM A351 CF8M
2	COVER	ASTM A351 CF8M
3	DISC	ASTM A182 F316
4	HINGE	ASTM A351 CF8M
5	HINGE PIN	ASTM A276 316
6	WASHER	ASTM A276 316
7	GASKET	316L+PTFE OR 316L+GRAPHITE
8	PLUG	ASTM A276 316
9	WASHER	ASTM A276 316
10	STUD	ASTM A193-B8 CL2
11	NUT	ASTM A194-8
12	DISC NUT	ASTM A276 316
13	PIN	ASTM A276 316
14	RIVET	ASTM A240 316
15	NAME PLATE	ASTM A276 316

As a corporate effort to be an integral member to protect the environment, Neway stands at the forefront in producing valves which meet the highest fugitive emission requirements.

Neway actively participates and develops standards and products which meet and exceed requirements. Many valves can be provided in accordance to ISO 15848, API 624, TA-Luft, or other customized solution.

Design Features

Low Emission Packing

Neway actively works with reputable and industry leading sealing solution companies to create low emission solutions that can cover valves from cryogenic to extreme high temperature in variety of endurance range down to 10ppm without usage of bellow seal.

Stuffing box and stem finish

All surface finish for Neway valve's stem and stuffing boxes are tightly controlled to achieve optimized surface finish for the designated sealing solution.

Optional Live-loaded Gland Bolts

Live-loaded gland bolts are optional upon customer request. The special structure can maintain a permanent packing stress using Belleville spring, and extend the low emission service life. Neway standard Belleville springs are protected by a weatherproof cap to keep them from environmental contamination so as to ensure a longmaintenance free service life

Fugitive Emission Valve Test

In addition to type testing, Neway offers production testing capabilities to ISO 15848-2, Shell MESG 77/312 or other customized testing standards.

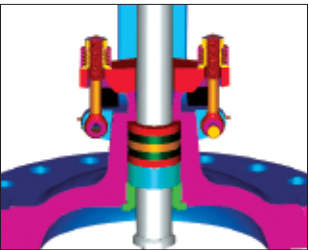

Size	Flanged, ASME CLASS 150 (PN 20)				Flanged, ASME CLASS 300 (PN 50)			
in mm	D	L	H	Weight lb(kg)	D	L	H	Weight lb(kg)
2	2.01	7.99	4.51	20.4	2.01	10.51	5.02	60.0
50	51	203	114.5	9.3	51	267	127.5	27.2
2-1/2	2.52	8.50	6.00	50.7	2.52	11.50	7.17	81.6
65	64	216	152.5	23.0	64	292	182	37.0
3	2.99	9.49	6.59	57.3	2.99	12.52	7.40	92.6
80	76	241	167.5	26.0	76	318	188	42.0
4	4.02	11.50	7.34	99.2	4.02	14.02	8.62	141.1
100	102	292	186.5	45.0	102	356	219	64.0
6	5.98	14.02	11.42	172	5.98	17.48	12.50	273.4
150	152	356	290	78.0	152	444	317.5	124.0
8	7.99	19.49	14.13	299.9	7.99	20.98	14.35	489.5
200	203	495	359	136.0	203	533	364.5	222.0
10	10.00	24.49	15.35	471.9	10.00	24.49	16.73	643.9
250	254	622	390	214.1	254	622	425	292.1
12	12.01	27.48	16.65	707.8				
300	305	698	423	321.1				
14	13.27	30.98	17.83	904.1				
350	337	787	453	410.1				
16	15.24	34.02	20.35	1133.4				
400	387	864	517	514.1				

Neway Factory



NEWAY Head Office

Total area: 2,295sqm
Office area: 6,885sqm

Founded in 2014



NEWAY Manufacturing Base

Main products: Ball Valve, Butterfly Valve, Gate Valve,
Globe Valve, Check Valve, Control Valve
Building area: 230,000 sqm
Work shop: 140,061 sqm

Founded in 2006
Expanded in 2013



NEWAY Foundry (Suzhou)

Main products: Sand Casting
Building area: 112,500 sqm
Work shop: 98,000 sqm

Founded in 2008
Expanded in 2015



NEWAY Foundry (Dafeng)

Main products: Lost wax investment casting
Building area: 40,000 sqm
Work shop: 20,000 sqm

Founded in 2008



Neway Precision Forging(Liyang),.LTD

Main products: Hammer forging, annular forging
Office area: 3,000 sqm
Work shop: 30,000 sqm

Founded in 2017



Neway Butterfly Valve Plant

Main products: Butterfly Valve
Building area: 30,000 sqm
Work shop: 19,000 sqm (first floor)
7,000 sqm (second floor)

Founded in 2020

Product Warranty

Seller will replace without charge or refund the purchase price of products provided by Seller which prove to be defective in material or workmanship, provided in each case that the product is properly installed and is used in the service for which Seller recommends it and that written claim, specifying the alleged defect, is presented to the Seller within 18 months from the date of shipment or 12 months after installation, whichever occurs first. Seller shall in no event bear any labor, equipment, engineering or other costs incurred in connection with repair or replacement. The warranty stated in this paragraph is in lieu of all other warranties, either expressed or implied. With respect to warranties, this paragraph states Buyer's exclusive remedy and seller's exclusive liability.